

FREE AIRFARE
LIMITED TIME OFFER. CALL FOR DETAILS.



11 DAYS • 23 MEALS • ZURICH > AMSTERDAM

TULIP TIME ON JEWELS OF THE RHINE

Switzerland • France • Germany • the Netherlands

Departure Date: April 21st, 2027

Sail the romantic Rhine River in spring and visit the world-famous Keukenhof Gardens, home to seven million blooms. Explore the charming Netherlands and cruise past windmills and tulip fields. Enjoy guided tours of Cologne, Koblenz, and Strasbourg, and visit Schwetzingen Palace. This remarkable journey includes two nights in Lucerne, Switzerland, nestled amid the breathtaking Swiss Alps.





Sail the romantic Rhine River

DAY 1 Depart the USA

Today you'll depart the USA on your overnight flight to Zurich, Switzerland.

DAY 2 Zurich to Lucerne, Switzerland

Upon arrival in Zurich, transfer to your hotel in Lucerne to begin your Swiss adventure. Flights should arrive by 3:00pm. The afternoon is at leisure to begin discovering your beautiful new surroundings. This evening, join your Mayflower representative and traveling companions for an included dinner at the hotel. *Meal: D*

DAY 3 Lucerne

After breakfast, an included walking tour highlights the city's landmark, the famous 14th-century Chapel Bridge with its paintings of heroic town events, that crosses the Reuss River. See the 17th-century Renaissance Town Hall and town squares, all set amongst the beautiful backdrop of the Swiss Alps. The remainder of the day is at leisure. *Meal: B*



Chapel Bridge crosses the Reuss River in Lucerne, Switzerland

DAY 4 Lucerne – Huningue, France

Before departing for your ship in Huningue, the day is free to enjoy at leisure or join the morning optional excursion to Mt. Pilatus – a mountain overlooking Lucerne that offers a unique alpine experience! This afternoon, travel by motorcoach to Huningue, France for embarkation of your Emerald Cruises luxury Star-Ship. This evening, join your fellow travelers for dinner onboard. *Meals: B, L, D*

DAY 5 Breisach, Germany / Freiburg

Today discover the enchanting city of Freiburg, nestled amidst the Black Forest. Explore its historic center, lined with colorful half-timbered houses and a vibrant market square. Wander through the picturesque botanical garden, showcasing a diverse array of flora. For a more active experience, choose an exhilarating bike tour around Breisach, a charming medieval town with stunning views of the Rhine River. Immerse yourself in the natural beauty and cultural richness of this captivating region. *Meals: B, L, D*

DAY 6 Kehl / Strasbourg, France

Arrive in Strasbourg, the capital city of the Alsace Region in France. The guided walking tour takes you along narrow lanes and across footbridges as you discover the Grande Île, the historical city center and UNESCO World Heritage Site. Known for its medieval black and white timber-framed buildings, picturesque le Petite France, old tanning houses, canals and river locks, the city's star attraction is the ornate cathedral, dominating the main square. This afternoon, the city is yours to explore at leisure. *Meals: B, L, D*

DAY 7 Mannheim, Germany - Schwetzingen

Relax onboard as the vessel cruises along the Rhine River to Mannheim. Upon arrival travel by coach to visit Schwetzingen Palace, famous for the beauty and harmony of its gardens. Visit the interior of the palace, along with the beautiful gardens, maintained in their original design. Today they remain a cultural heritage site of European significance, and contain more than 100 sculptures scattered throughout the grounds. Alternatively, embark on an active journey



Strasbourg, France

to the quaint wellness town of Bad-Dürkheim for a hike through the beautiful vineyards. This evening, enjoy local entertainment onboard.
Meals: B, L, D

DAY 8 Koblenz

Begin the day sailing through the spectacular UNESCO World Heritage Rhine Gorge. Pass countless medieval castles and vineyards lining the shores of this section of the river, with photo opportunities around every bend. See the infamous Lorelei statue and Pfalzgrafenstein Castle, built on an island in the middle of the river as a medieval toll station. Continue cruising to the 2000-year-old town of Koblenz, situated at the confluence of the Rhine and Moselle Rivers. Enjoy a walking tour of Koblenz seeing the German Corner where the 2 rivers meet and the Church of Our Lady. Meals: B, L, D

DAY 9 Düsseldorf – Cologne

Join a walking tour of Düsseldorf, a vibrant city renowned for its stylish boutiques and charming Old Town. Stroll along the picturesque Rhine River, admire the stunning architecture, and discover hidden gems off the beaten path. Later this day we will arrive in Cologne, famous for its Gothic Cathedral. This afternoon you can immerse yourself in the city's lively atmosphere, indulge in delicious local cuisine, and experience the unique charm of the city. Meals: B, L, D

DAY 10 Amsterdam, the Netherlands

This morning, depart by coach for an included visit to the world-famous Keukenhof Gardens. Discover why it's called the "Garden of Europe" as you wander along the paths, admiring gorgeous flowers at the peak of tulip season. Unique flower shows in the pavilions along with colorful, artistic floral displays throughout the manicured garden, are sure to please! Return to the ship in the afternoon to explore the city of Amsterdam at your leisure. Meals: B, L, D

DAY 11 Amsterdam / USA

Bid 'auf wiedersehen' to Europe and return home with memories of life enriching experiences from your European adventure and cruise along the Rhine River during tulip time. Meal: B



EXCEPTIONAL INCLUSIONS

- 23 Meals: 9 breakfasts, 6 lunches and 8 dinners
- Airport transfers on tour dates when air is provided by Mayflower Cruises & Tours
- Visit four countries
- Two-night hotel stay and touring in Lucerne
- Seven-nights in a suite or stateroom of your choice onboard the vessel
- First-class service by an English-speaking crew
- All gratuities included
- Explore the magnificent Keukenhof Gardens
- Shore excursions with English-speaking local guides
- Visit UNESCO World Heritage Sites
- Personal listening device for shore excursions
- All meals included onboard
- Variety of international cuisine
- Complimentary regional wines, beer and soft drinks with onboard lunches and dinners
- Onboard Activity Manager will support all EmeraldACTIVE excursions and host daily onboard wellness activities, games, classes and evening entertainment
- Complimentary bottled water in your stateroom
- Complimentary WiFi onboard
- Complimentary bicycles onboard for use ashore
- All port charges included

Itinerary and excursions are subject to change.
Additional excursions will be released approximately 180 days prior to departure.

CRUISE AND HOTEL ACCOMMODATIONS

Days 2 and 3 – Hotel Europe or similar, Lucerne, Switzerland

Days 4 through 10 – Aboard an Emerald Cruises Star-Ship

Post-cruise hotel stays available in Amsterdam. Call for details.

EMERALD STAR-SHIPS

Built: 2014-2026 Cabins: 91 Guests: 180 Length: 443 ft. Crew: 52



- 1 Sun Deck with Deck Chairs*
- 2 Navigation Bridge
- 3 Sky Barbecue
- 4 Golf Putting Green
- 5 Games Area
- 6 Retractable Glass Roof
- 7 Walking Track
- 8 Daytime Pool & Bar/Evening Cinema
- 9 The Terrace
- 10 Horizon Bar & Lounge
- 11 Lift
- 12 Reception
- 13 Wellness Area
- 14 Fitness Area
- 15 Reflections Restaurant

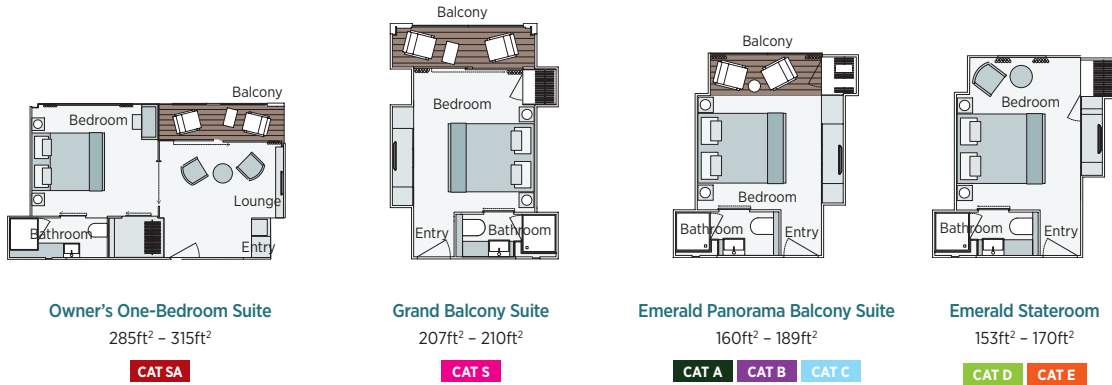

Important Information: The cabin and deck plans, sizes and photographs are an indication only and are subject to variation. * Due to safety, the Sun Deck will be closed when travelling under low bridges.

Tour Code 802PC 2027 Departure Date	RIVIERA DECK		VISTA DECK		HORIZON DECK					
	CAT E, D		CAT C, B		CAT A		CAT S		CAT SA	
	PER PERSON TWIN	SINGLE ROOM	PER PERSON TWIN	SINGLE ROOM	PER PERSON TWIN	SINGLE ROOM	PER PERSON TWIN	SINGLE ROOM	PER PERSON TWIN	SINGLE ROOM
April 21	\$5,639	+ \$4,229	\$6,549	+ \$4,919	\$7,019	+ \$5,269	\$7,515	N/A	\$8,519	N/A

Receive FREE AIRFARE from Chicago when booked by May 31st, 2026. Early Booking Bonus of \$200 p/p when booked by March 31st, 2026!
If booking after April 1st, 2026, please call for the most current savings promotion offer.

Mayflower Cruises & Tours' Guaranteed Share Program is available on the Riviera, Vista, and Horizon Decks standard cabins only when booked 6 months or more prior to departure.

Passport required on this program

Complimentary round trip local pick up from The Bethany Church @ 1315 Washington Ave, Sheboygan, with 15 or more. (With less than 15, pick up is from the Sheboygan Walmart Super Center South.

Air itineraries may not be available until documents are received. Air seats are assigned by the airline for the entire group and may not be available until airport check-in. Seat changes can only be attempted at the airport and may not be possible. If specific seat assignments are vital to your reservation, we recommend booking air on your own rather than booking air with the group.

Travelers Protection Plan (TPP) for River Cruises - \$569 per person (optional)

This nonrefundable fee will provide a refund to you during the instance that you have to cancel your trip. The cancellation has to be for a covered reason (see Plan for details on coverage) and we have to be notified at least one day prior to departure. If you must leave the tour early due to personal illness or the illness or death of an immediate family member, TPP will provide a refund for any unused services after the departure of the tour. Other benefits include medical expenses for illness and injury, emergency transportation, 24 hour hot line and lost or stolen baggage assistance. Return air transportation is included ONLY if your air tickets are purchased through Mayflower Cruises & Tours. Please review the Plan for details on coverage. Should you choose not to purchase our TPP, the following per person cancellation charges will be assessed for all tours and optional excursion costs:

- 121 days or more prior to departure: Deposit Amount
- 120 days to day of departure: 100% of total tour
- No refund on unused portions of the tour



Exclusions: Mayflower Cruises & Tours reserves the right to alter its Refund and Cancellation Policy when a substantial amount of cancellation or postponement of travel is attributable to: conditions resulting from an act of God, natural or man-made disaster, fire, government action, civil disorder, war, hostilities between nations, or unavailability of transportation through no fault of Mayflower Cruises & Tours. Plan and benefits offered and administered by Trip Mate, Inc.

FOR RESERVATIONS OR INFORMATION CONTACT:



Jill Posewitz: (920) 458-7311

jill@traveladvantagellc.com

traveladvantagellc.com

